

Seating System Armrests IPB, International

This Illustrated Parts Breakdown (IPB) Catalog has been compiled from the latest product information available at the time of publication. Quantum Rehab® / Pride Mobility Products® Corporation reserves the right to make changes and updates to this manual and to the product(s) it represents. Any changes, updates, or improvements to the product(s) may result in slight differences between this manual and the product that has been purchased.

An IPB is a graphically portrayed parts listing of product components which have been deemed to have serviceable, maintenance significance. When applicable, IPBs utilize “exploded” illustrations that detail serviceable components and a corresponding itemized parts list of reference numbers, part numbers, descriptions, quantities, and any applicable pricing. Most product components are incorporated into assemblies and may not be available for replacement.

Serviceable components will be noted by a callout in the illustration that will correspond to a alphanumeric reference number in the parts list. Items may also be listed in the parts list by parent assemblies. In most cases when a parent assembly is listed, there will be child parts or sub-assemblies listed under that parent.

For example: The parent assembly reference number is A1 — A5. That part contains all of the items listed as and contained within A1, A2, A3, A4, & A5. As long as these subcomponents have a callout associated with them, they can be selected for replacement or quote.

Updates to the contents of an IPB will be made on a regular basis based upon applicable product changes and enhancements. This PDF catalog has been export from the Provider based service site. The most up to date parts look up tool and ordering application is located at: prideprovider.com. Please utilize this system to enhance your user experience. It is built with highly interactive materials that are set with relational properties that will facilitate easier part look-up, more accurate parts selection, notification of onhand part availability, and quick links to related documents and products.

We welcome all questions and comments regarding the Quantum Rehab® / Pride Mobility Products® Corporation IPB systems.

Any pricing that is included in Quantum Rehab® /Pride Mobility Products® Corporation IPBs is subject to change without prior notice.

Thank you for choosing products from Quantum Rehab® and Pride Mobility Products® Corporation.



1.2. Version 1 & 2 Flip-back Armrests and Pads

Complete Assy's

Version 2 Standard Armrest Matrix , TB3 (Black)- 12"-24" W Seats 1

Version 2 Standard Armrest Matrix , TB3 (Black) - 24"-32" W Seats 3

Version 1 Standard Armrest Matrix, TB3 (Grey) - 12"-24" W Seats 5

Armrests and Serviceable Components

Standard V2 TB3 Armrest Assys, Desk & Full Length6

Standard V1 & V2 TB3 Armrest, Width Linkage Assys 9

Standard V1 & V2 TB3 Armrest, Misc. Serviceable Hardware 11

Armpads

Armpads, TB3 Arms 13

Downpost Assy's

Straight Armrest Downpost Assembly, TB3 V1 and V2 Arms 15

Endo/Meso Armrest Downpost Assembly, TB3 V1 and V2 Arms 17

Appendix A:Pages Index 19

Appendix B:Parts Index20

Complete Assy's

- Please note:
- The complete armrest assemblies include all the hardware needed to mount the armrest to the back of the unit.
 - The armpads and armpad mounting hardware are NOT included and must be selected separately if needed .

Full Length			
Ref	Seat Width	Arm Height	Side
A1	12" - 20"	8" x 12"	Right
B1	12" - 20"	8" x 12"	Left
C1	12" - 20"	12" x 16"	Right
D1	12" - 20"	12" x 16"	Left
E1	20" - 24"	8" x 12"	Right
F1	20" - 24"	8" x 12"	Left
G1	20" - 24"	12" x 16"	Right
H1	20" - 24"	12" x 16"	Left

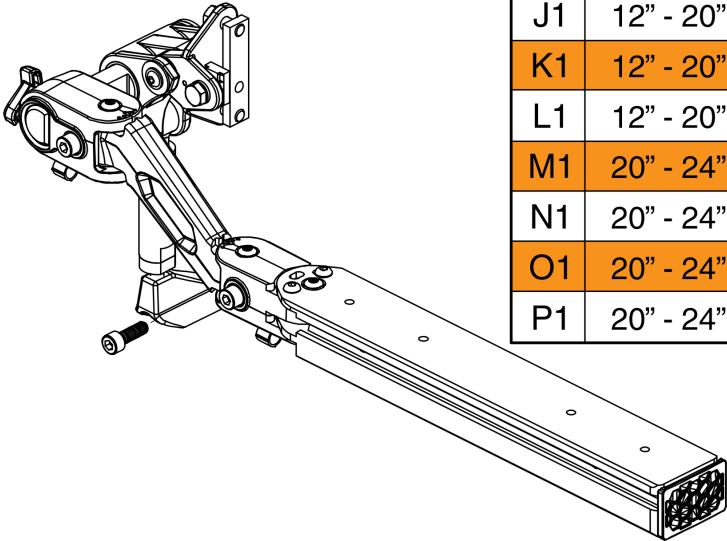

Desk Length			
Ref	Seat Width	Arm Height	Side
I1	12" - 20"	8" x 12"	Right
J1	12" - 20"	8" x 12"	Left
K1	12" - 20"	12" x 16"	Right
L1	12" - 20"	12" x 16"	Left
M1	20" - 24"	8" x 12"	Right
N1	20" - 24"	8" x 12"	Left
O1	20" - 24"	12" x 16"	Right
P1	20" - 24"	12" x 16"	Left



Item	Part No.	Name	Qty
A1	ARM147738	ARMREST,ASSY,12"-20"W,8"-12"H,FULL LENGTH,V2,TB3,RIGHT	1
B1	ARM147696	ARMREST,ASSY,12"-20"W,8"-12"H,FULL LENGTH,V2,TB3,LEFT	1
C1	ARM147742	ARMREST,ASSY,12"-20"W,12"-16"H,FULL LENGTH,V2,TB3,RIGHT	1
D1	ARM147740	ARMREST,ASSY,12"-20"W,12"-16"H,FULL LENGTH,V2,TB3,LEFT	1
E1	ARM147743	ARMREST,ASSY,20"-24"W,8"-12"H,FULL LENGTH,V2,TB3,RIGHT	1
F1	ARM147810	ARMREST,ASSY,20"-24"W,8"-12"H,FULL LENGTH,V2,TB3,LEFT	1
G1	ARM147749	ARMREST,ASSY,20"-24"W,12"-16"H,FULL LENGTH,V2,TB3,RIGHT	1
H1	ARM147747	ARMREST,ASSY,20"-24"W,12"-16"H,FULL LENGTH,V2,TB3,LEFT	1
I1	ARM147746	ARMREST,ASSY,12"-20"W,8"-12"H,DESK LENGTH,V2,TB3,RIGHT	1
J1	ARM147744	ARMREST,ASSY,12"-20"W,8"-12"H,DESK LENGTH,V2,TB3,LEFT	1
K1	ARM147797	ARMREST,ASSY,12"-20"W,12"-16"H,DESK LENGTH,V2,TB3,RIGHT	1
L1	ARM147748	ARMREST,ASSY,12"-20"W,12"-16"H,DESK LENGTH,V2,TB3,LEFT	1
M1	ARM147812	ARMREST,ASSY,20"-24"W,8"-12"H,DESK LENGTH,V2,TB3,RIGHT	1
N1	ARM147811	ARMREST,ASSY,20"-24"W,8"-12"H,DESK LENGTH,V2,TB3,LEFT	1
O1	ARM147817	ARMREST,ASSY,20"-24"W,12"-16"H,DESK LENGTH,V2,TB3,RIGHT	1
P1	ARM147813	ARMREST,ASSY,20"-24"W,12"-16"H,DESK LENGTH,V2,TB3,LEFT	1

Complete Assy's

Please note:

- The complete armrest assemblies include all the hardware needed to mount the armrest to the back of the unit.
- The armpads and armpad mounting hardware are NOT included and must be selected separately if needed .

Full Length			
Ref	Seat Width	Arm Height	Side
A1	24" - 28"	8" x 12"	Right
B1	24" - 28"	8" x 12"	Left
C1	24" - 28"	12" x 16"	Right
D1	24" - 28"	12" x 16"	Left
E1	28" - 32"	8" x 12"	Right
F1	28" - 32"	8" x 12"	Left
G1	28" - 32"	12" x 16"	Right
H1	28" - 32"	12" x 16"	Left

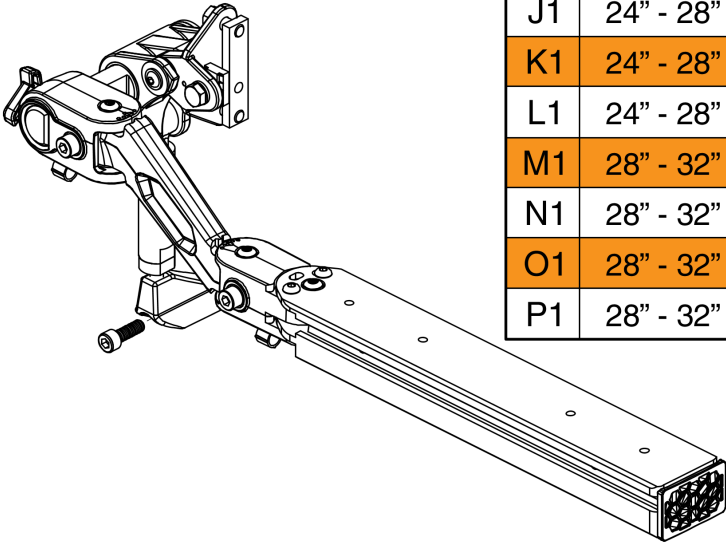

Desk Length			
Ref	Seat Width	Arm Height	Side
I1	24" - 28"	8" x 12"	Right
J1	24" - 28"	8" x 12"	Left
K1	24" - 28"	12" x 16"	Right
L1	24" - 28"	12" x 16"	Left
M1	28" - 32"	8" x 12"	Right
N1	28" - 32"	8" x 12"	Left
O1	28" - 32"	12" x 16"	Right
P1	28" - 32"	12" x 16"	Left



Item	Part No.	Name	Qty
A1	ARM147822	ARMREST,ASSY,24"-28"W,8"-12"H,FULL LENGTH,V2,TB3,RIGHT	1
B1	ARM147820	ARMREST,ASSY,24"-28"W,8"-12"H,FULL LENGTH,V2,TB3,LEFT	1
C1	ARM147839	ARMREST,ASSY,24"-28"W,12"-16"H,FULL LENGTH,V2,TB3,RIGHT	1
D1	ARM147838	ARMREST,ASSY,24"-28"W,12"-16"H,FULL LENGTH,V2,TB3,LEFT	1
E1	ARM147846	ARMREST,ASSY,28"-32"W,8"-12"H,FULL LENGTH,V2,TB3,RIGHT	1
F1	ARM147844	ARMREST,ASSY,28"-32"W,8"-12"H,FULL LENGTH,V2,TB3,LEFT	1
G1	ARM147855	ARMREST,ASSY,28"-32"W,12"-16"H,FULL LENGTH,V2,TB3,RIGHT	1
H1	ARM147850	ARMREST,ASSY,28"-32"W,12"-16"H,FULL LENGTH,V2,TB3,LEFT	1
I1	ARM147841	ARMREST,ASSY,24"-28"W,8"-12"H,DESK LENGTH,V2,TB3,RIGHT	1
J1	ARM147840	ARMREST,ASSY,24"-28"W,8"-12"H,DESK LENGTH,V2,TB3,LEFT	1
K1	ARM147843	ARMREST,ASSY,24"-28"W,12"-16"H,DESK LENGTH,V2,TB3,RIGHT	1
L1	ARM147842	ARMREST,ASSY,24"-28"W,12"-16"H,DESK LENGTH,V2,TB3,LEFT	1
M1	ARM147864	ARMREST,ASSY,28"-32"W,8"-12"H,DESK LENGTH,V2,TB3,RIGHT	1
N1	ARM147863	ARMREST,ASSY,28"-32"W,8"-12"H,DESK LENGTH,V2,TB3,LEFT	1
O1	ARM147867	ARMREST,ASSY,28"-32"W,12"-16"H,DESK LENGTH,V2,TB3,RIGHT	1
P1	ARM147865	ARMREST,ASSY,28"-32"W,12"-16"H,DESK LENGTH,V2,TB3,LEFT	1

Complete Assy's

The complete Version 1 TB3 Flip-back Armrest Assy's have been discontinued and are no longer available for replacement.

Please contact Technical Service for replacement options.

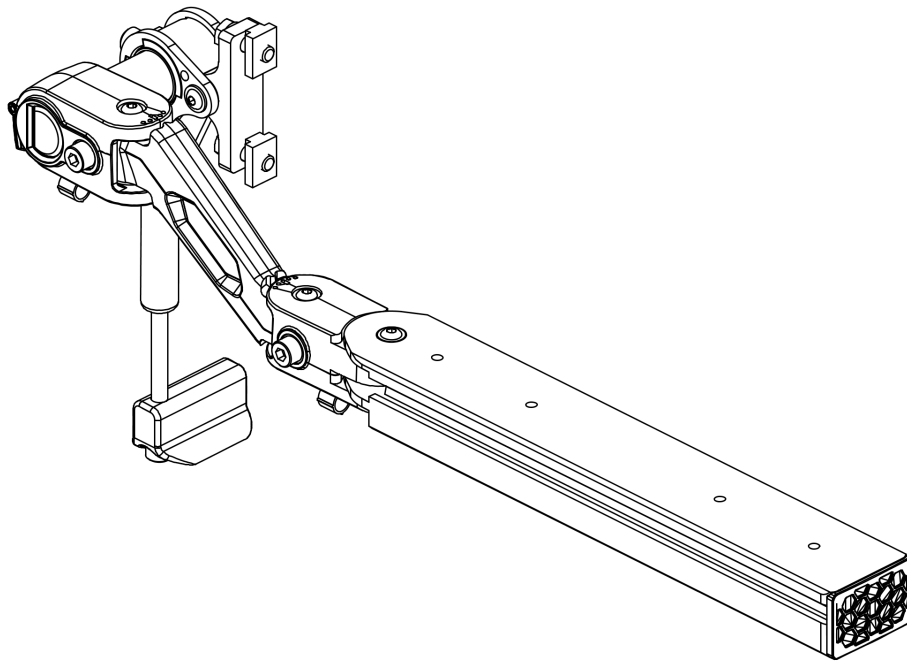

This page intentionally left blank

Armrests and Serviceable Components

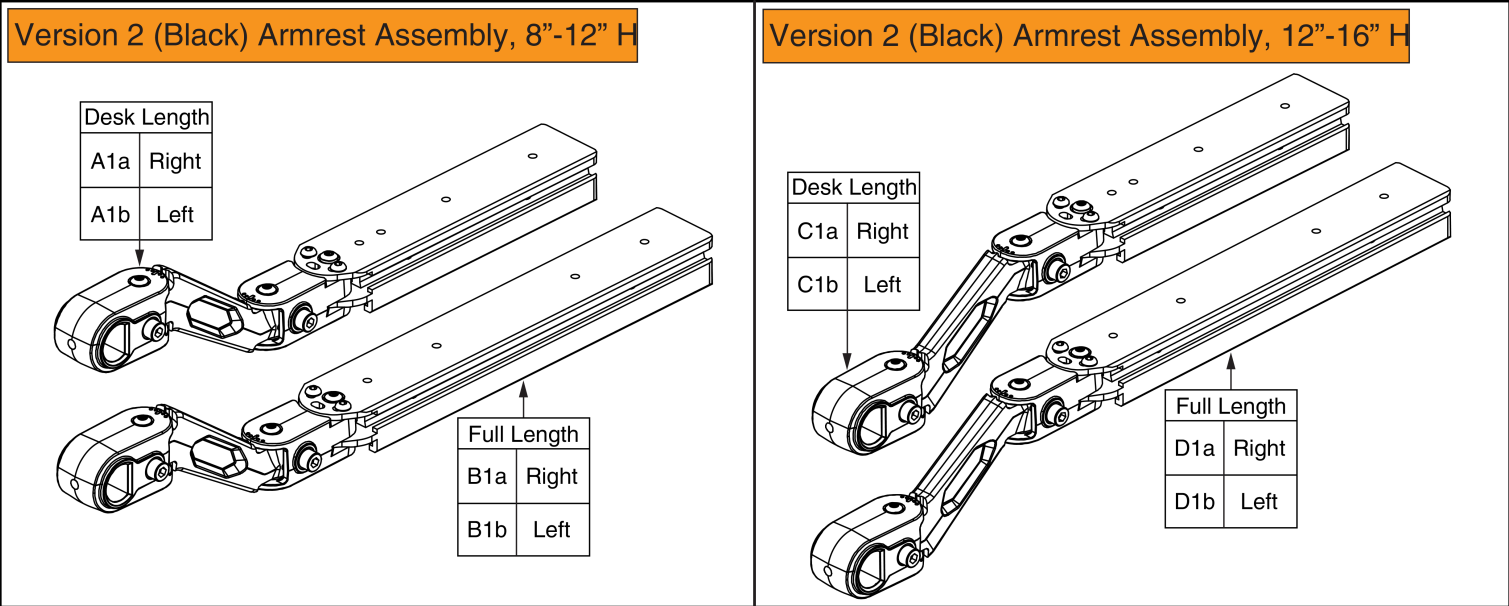



Item	Part No.	Name	Qty
A1a	MEC143466	ARMREST 2,ASSY,8"H-12"H,DESK LENGTH,TB3,RIGHT,V2	1
A1b	MEC143461	ARMREST 2,ASSY,8"H-12"H,DESK LENGTH,TB3,LEFT,V2	1
B1a	MEC143458	ARMREST 2,ASSY,8"H-12"H,FULL LENGTH,TB3,RIGHT,V2	1
B1b	MEC143410	ARMREST 2,ASSY,8"H-12"H,FULL LENGTH,TB3,LEFT,V2	1
C1a	MEC143470	ARMREST 2,ASSY,12"H-16"H,DESK LENGTH,TB3,RIGHT,V2	1
C1b	MEC143469	ARMREST 2,ASSY,12"H-16"H,DESK LENGTH,TB3,LEFT,V2	1
D1a	MEC143460	ARMREST 2,ASSY,12"H-16"H,FULL LENGTH,TB3,RIGHT,V2	1
D1b	MEC143459	ARMREST 2,ASSY,12"H-16"H,FULL LENGTH,TB3,LEFT,V2	1

Armrests and Serviceable Components

Version 2 (Black) Armrest Linkage Assy

A5D	28"-32"W
A5C	24"-28"W
A5B	20"-24"W

A1a - A5A	12"-20"W
A1a - A5B	20"-24"W
A1a - A5C	24"-28"W
A1a - A5D	28"-32"W

A1b - A5A	12"-20"W
A1b - A5B	20"-24"W
A1b - A5C	24"-28"W
A1b - A5D	28"-32"W

Version 1 (Grey) Armrest Linkage Assy

N/A	28"-32"W
N/A	24"-28"W
B4B	20"-24"W

B1a - B4A	12"-20"W
B1a - B4B	20"-24"W
N/A	24"-28"W
N/A	28"-32"W

B1b - B4A	12"-20"W
B1b - B4B	20"-24"W
N/A	24"-28"W
N/A	28"-32"W

Only serviceable components contain callouts.

Item	Part No.	Name	Qty
A1a - A5A	ARM147739	ARMREST,ASSY,16"W-20"W,W/LINKAGE,RIGHT,TB3,V2, This Assy is utilized on Arm Width ranges of 12" to 20".	1
A1a - A5B	ARM147745	ARMREST,ASSY,20"W-24"W,W/LINKAGE,RIGHT,TB3,V2	1
A1a - A5C	ARM147823	ARMREST,ASSY,24"W-28"W,W/LINKAGE,RIGHT,TB3,V2	1
A1a - A5D	ARM147847	ARMREST,ASSY,28"W-32"W,W/LINKAGE,RIGHT,TB3,V2	1
A1a	MEC138277	ARM ARTICULATION,ASSY,RIGHT,TRU BALANCE 3 ARMREST,V2	1
A1b - A5A	ARM147707	ARMREST,ASSY,16"W-20"W,W/LINKAGE,LEFT,TB3,V2, This Assy is utilized on Arm Width ranges of 12" to 20".	1
A1b - A5B	ARM147741	ARMREST,ASSY,20"W-24"W,W/LINKAGE,LEFT,TB3,V2	1
A1b - A5C	ARM147821	ARMREST,ASSY,24"W-28"W,W/LINKAGE,LEFT,TB3,V2	1
A1b - A5D	ARM147845	ARMREST,ASSY,28"W-32"W,W/LINKAGE,LEFT,TB3,V2	1
A1b	MEC138221	ARM ARTICULATION,ASSY,LEFT,TRU BALANCE 3 ARMREST,V2	1
A2	HDW148456	SFHCs,M6-1.0 X 25MM,ISO 10624,CLASS 10.9,W/PATCH	1
A3	MEC138229	FLIP UP STOP PLATE,VERSION 2,TRU BALANCE 3	1
A4	MEC138230	FRICTION WASHER,VERSION 2,TRU BALANCE 3 ARMREST	1
A5A	MEC138452	WIDTH BAR,ASSY,12"W-20"W,TRU-BALANCE 3 ARMREST,V2	1
A5B	MEC141919	WIDTH BAR,ASSY,20"W-24"W,TRU BALANCE 3 ARMREST,V2	1
A5C	MEC141920	WIDTH BAR,ASSY,24"W-28"W,TRU BALANCE 3 ARMREST,V2	1
A5D	MEC141921	WIDTH BAR,ASSY,28"W-32"W,TRU BALANCE 3 ARMREST,V2	1
B1a - B4A		ARMREST,ASSY,16"W-20"W,W/LINKAGE,RIGHT,TB3,V1, This Assy is utilized on Arm Width ranges of 12" to 20".	1
B1a - B4B	ARM138392	ARMREST,ASSY,20"W-24"W,W/LINKAGE,RIGHT,TB3,V1	1
B1a		ARMREST,ASSY,LINKAGE,RIGHT,TRU-BALANCE 3,V1	1
B1b - B4A	ARM138389	ARMREST,ASSY,16"W-20"W,W/LINKAGE,LEFT,TB3,V1, This Assy is utilized on Arm Width ranges of 12" to 20".	1
B1b - B4B	ARM138391	ARMREST,ASSY,20"W-24"W,W/LINKAGE,LEFT,TB3,V1	1
B1b	MEC123250	ARMREST,ASSY,LINKAGE,LEFT,TRU-BALANCE 3,V1	1
B2	SCRSHCS1336	SCREW,SHCS,BLACK ZINC,M8-1.25 X 25MM,GRADE 12.9,W/NYLON PATCH	1
B3	MEC124686	FRICTION WASHER, TRU-BALANCE 3 ARMREST,V1	1
B4A		WIDTH ADJUSTMENT BAR,ASSY,16"W-20"W,TB3 ARMREST,V1	1
B4B		WIDTH ADJUSTMENT BAR,ASSY,20"W-24"W,TB3 ARMREST,V1	1
C1	DGN143409	KNOB,PLASTIC,PARTIALLY THREADED,M8-1.25 X 16MM	1
D1		ARMREST,ASSY,LOWER PIVOT,TRU-BALANCE 3,V1	1
E1	NUTJAM1015	NUT,JAM,BLACK ZINC,M8-1.25	2
F1	SCR8120022	SCREW,SHCS,BLACK ZINC,M8-1.25 X 135MM,CUSTOM	1
G1	HDW134332	KNOB,PLASTIC,THREADED STUD,M8-1.25 X 25MM	1

Armrests and Serviceable Components

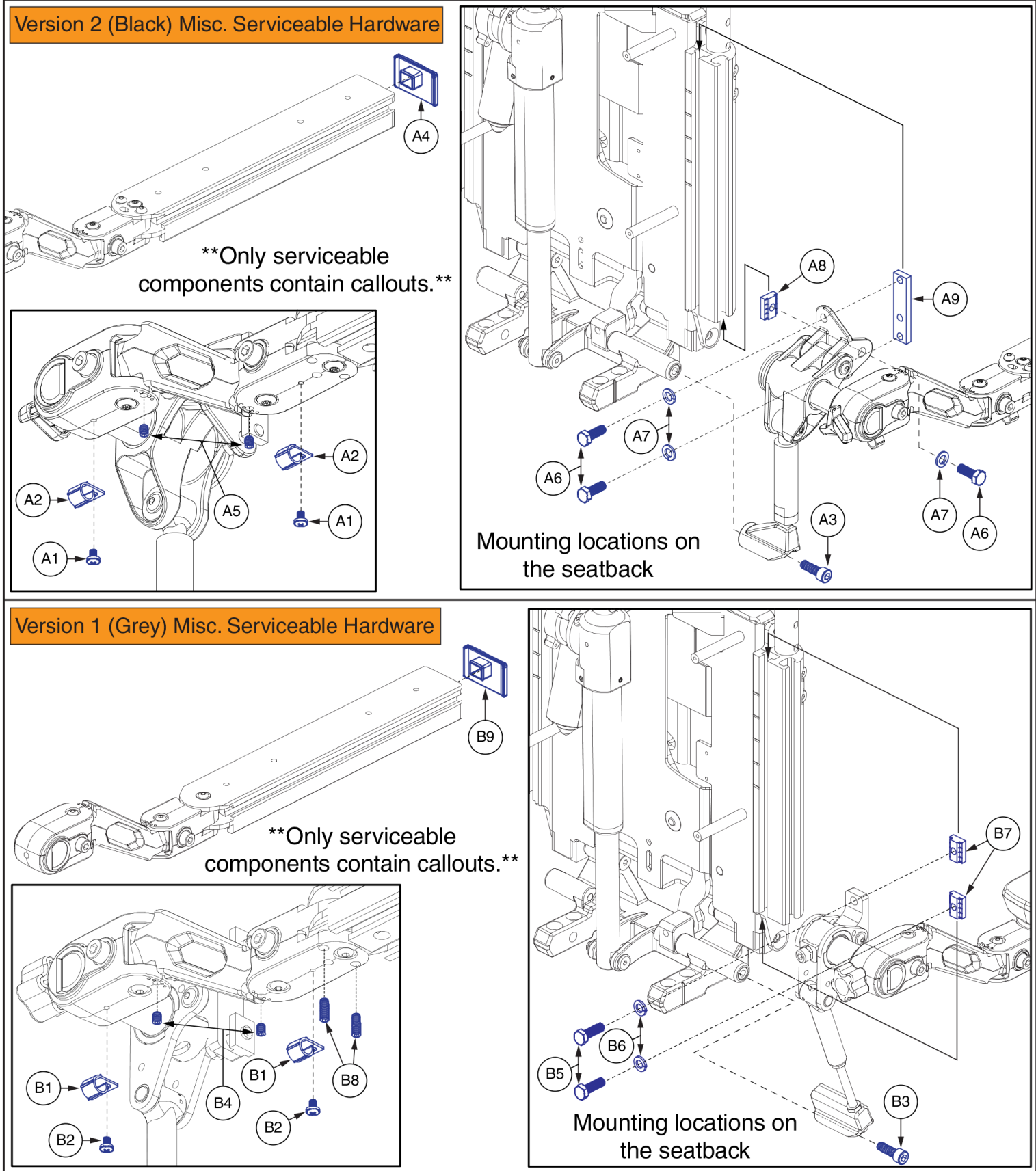



Item	Part No.	Name	Qty
A1	SCRPPH1304	SCREW,PPH,BLACK ZINC,M4-.7 X 6MM	2
A2	CLPCBLC1028	CLAMP,CABLE,BLACK,NYLON,.38" DIAMETER,P-CLIP,C-1059-042	2
A3	SCRSHCS1336	SCREW,SHCS,BLACK ZINC,M8-1.25 X 25MM,GRADE 12.9,W/NYLON PATCH	1
A4	DGN123650	END CAP,ARM EXTRUSION,PLASTIC,TRU-BALANCE 3	1
A5	SCRSETS1105	SCREW,SET,M6-1.0T X 8MM,CUP POINT,W/NYLON PATCH	2
A6	SCRHHCS1282	SCREW,HHCS,BLACK ZINC CHROMATE,M8-1.25 X 20MM,GRADE 12.9	3
A7	WASLOCK1039	WASHER,LOCK,BLACK ZINC,M8,SPLIT	3
A8	NUT8120005	NUT,T-SLOT,BLACK,M8-1.25	1
A9	MEC121306	SLOT-NUT,ACCESSORY BRACKET,TRU-BALANCE 3	1
B1	CLPCBLC1028	CLAMP,CABLE,BLACK,NYLON,.38" DIAMETER,P-CLIP,C-1059-042	2
B2	SCRPPH1304	SCREW,PPH,BLACK ZINC,M4-.7 X 6MM	2
B3	SCRSHCS1336	SCREW,SHCS,BLACK ZINC,M8-1.25 X 25MM,GRADE 12.9,W/NYLON PATCH	1
B4	SCRSETS1105	SCREW,SET,M6-1.0T X 8MM,CUP POINT,W/NYLON PATCH	2
B5	SCRHHCS1322	SCREW, HEX HEAD, M8x1.25 x 25, ISO 4014, CL 10.9, BZ	2
B6	WASLOCK1039	WASHER,LOCK,BLACK ZINC,M8,SPLIT	2
B7	NUT8120005	NUT,T-SLOT,BLACK,M8-1.25	2
B8	HDW122303	SCREW,SET,BLACK ZINC,M6-1.0 X 25MM L,ASTM F912M	1
B9	DGN123650	END CAP,ARM EXTRUSION,PLASTIC,TRU-BALANCE 3	1

Armpads

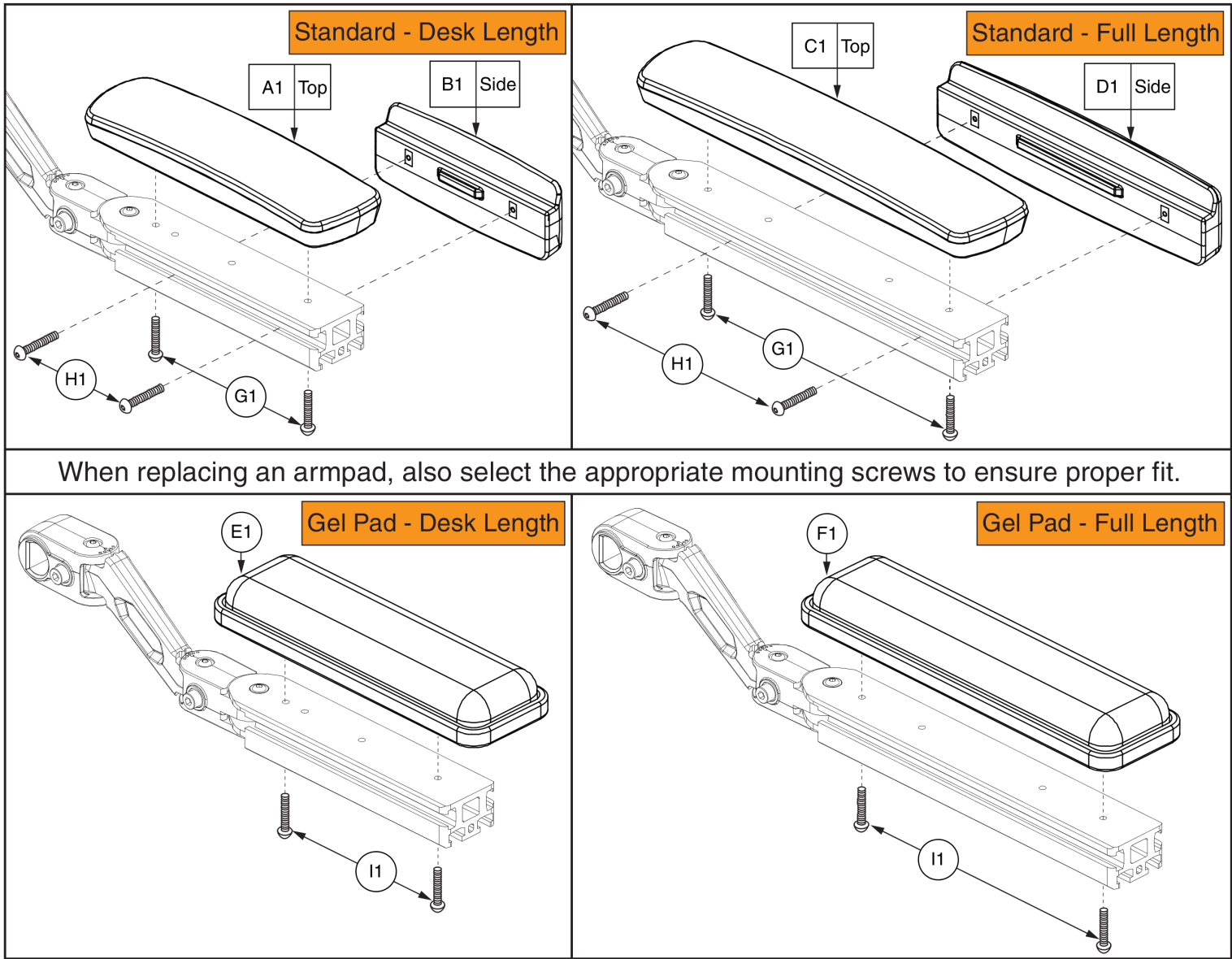



Item	Part No.	Name	Qty
A1	DGN142128	ARMPAD,TOP,DESK LENGTH,VERSION 2,TRU-BALANCE 3	1
B1	DGN142125	ARMPAD,SIDE,DESK LENGTH,VERSION 2,TRU-BALANCE 3	1
C1	DGN142014	ARMPAD,TOP,FULL LENGTH,VERSION 2,TRU-BALANCE 3	1
D1	DGN142104	ARMPAD,SIDE,FULL LENGTH,VERSION 2,TRU-BALANCE 3	1
E1	ARM136409	ARMPAD,GEL,BLACK,10"L,DESK LENGTH,(310G)	1
F1	ARM136408	ARMPAD,GEL,BLACK,14",FULL LENGTH,(314G)	1
G1	SCRPPH1326	SCREW,PPH,BLACK ZINC,M4-.7 X 40MM	2
H1	HDW134520	SCREW,PPH,BLACK ZINC,M4-.7 X 50MM	2
I1	SCRSHCS1244	SCREW,SHCS,BLACK ZINC,10-32 X 1.25"	2

Downpost Assy's

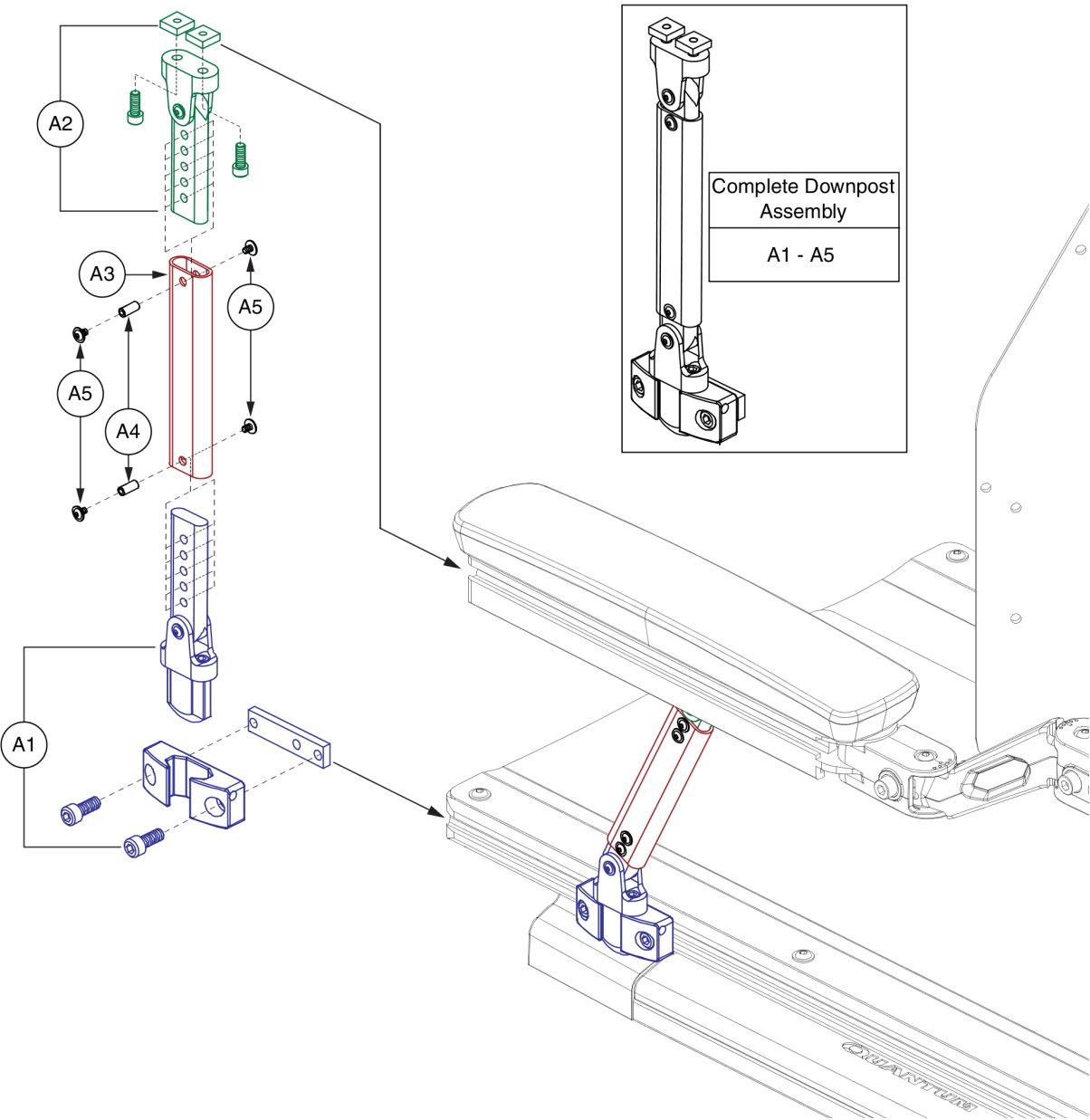



Item	Part No.	Name	Qty
A1 - A5	MEC133331	DOWN POST,ASSY,TRU-BALANCE 3 ARMREST	1
A1	MEC133236	DOWN POST,ASSY,LOWER ARM COLUMN,TRU-BALANCE 3	1
A2	MEC133237	DOWN POST,ASSY,UPPER ARM COLUMN,TRU-BALANCE 3	1
A3	MEC124092	DOWN POST ARM COLUMN,UPPER TUBE,TB3 ARMREST	1
A4	MEC133900	HEIGHT ADJUSTABLE ARM COLUMN PIVOT PIN	2
A5	HDW133899	SCREW,BHSCS,BLACK ZINC,M4-0.7 X 6MM,FLANGED,10.9,PATCH	4

Downpost Assy's

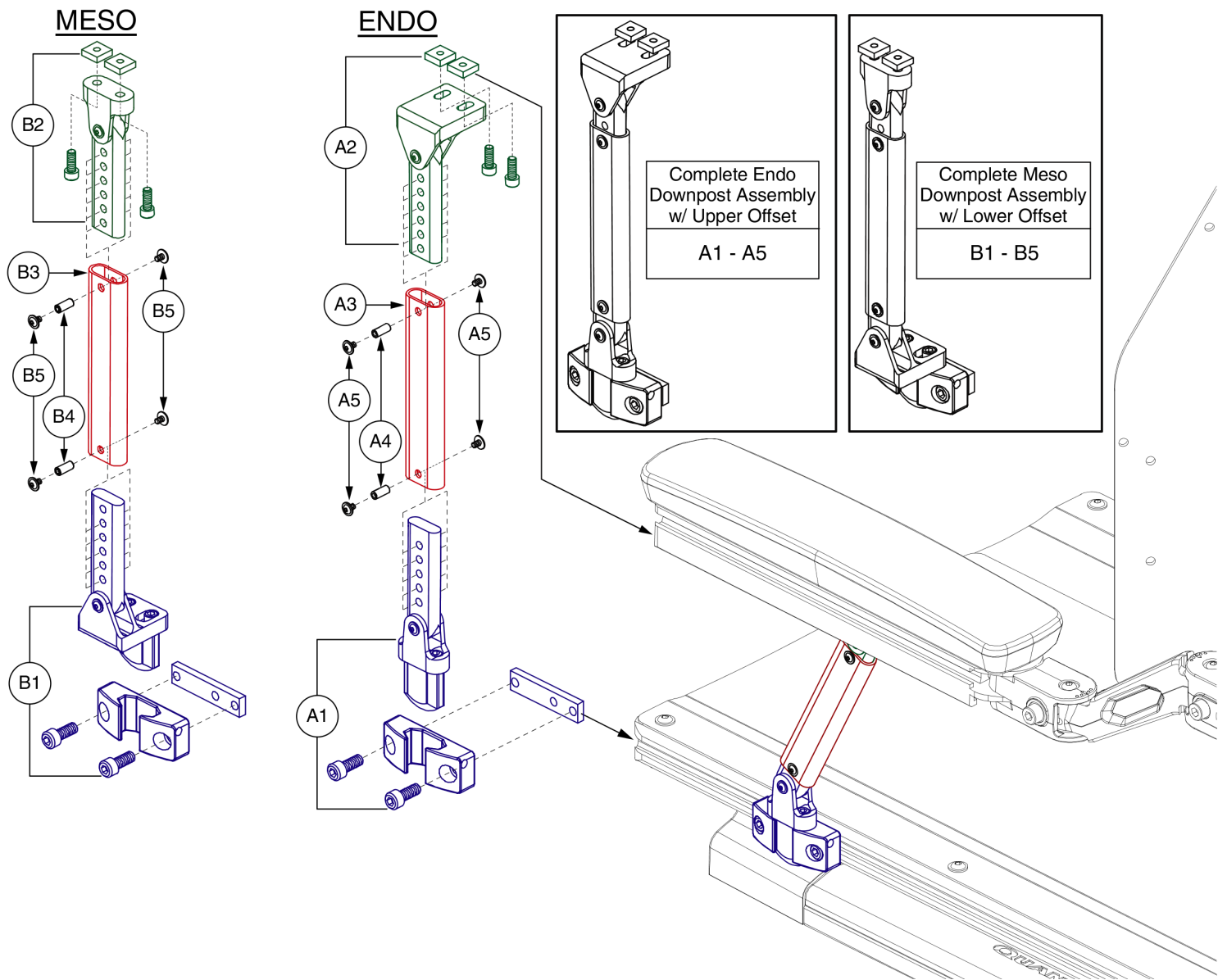



Item	Part No.	Name	Qty
A1 - A5	MEC137979	DOWN POST,ASSY,ENDOMORPH,TRU-BALANCE 3	1
A1	MEC133236	DOWN POST,ASSY,LOWER ARM COLUMN,TRU-BALANCE 3	1
A2	MEC137937	UPPER ARM,ENDOMORPH/MESOMORPH,TRU-BALANCE 3	1
A3	MEC124092	DOWN POST ARM COLUMN,UPPER TUBE,TB3 ARMREST	1
A4	MEC133900	HEIGHT ADJUSTABLE ARM COLUMN PIVOT PIN	2
A5	HDW133899	SCREW,BHSCS,BLACK ZINC,M4-0.7 X 6MM,FLANGED,10.9,PATCH	4
B1 - B5	MEC166425	DOWN POST,ASSY,MESOMORPH,TRU-BALANCE 3	1
B1	MEC137938	LOWER ARM,ENDOMORPH/MESOMORPH,TRU-BALANCE 3	1
B2	MEC133237	DOWN POST,ASSY,UPPER ARM COLUMN,TRU-BALANCE 3	1
B3	MEC124092	DOWN POST ARM COLUMN,UPPER TUBE,TB3 ARMREST	1
B4	MEC133900	HEIGHT ADJUSTABLE ARM COLUMN PIVOT PIN	2
B5	HDW133899	SCREW,BHSCS,BLACK ZINC,M4-0.7 X 6MM,FLANGED,10.9,PATCH	4

Appendix A:Pages Index

Armpads, TB3 Arms	13
Endo/Meso Armrest Downpost Assembly, TB3 V1 and V2 Arms	17
Standard V1 & V2 TB3 Armrest, Misc. Serviceable Hardware	11
Standard V1 & V2 TB3 Armrest, Width Linkage Assys	9
Standard V2 TB3 Armrest Assys, Desk & Full Length	6
Straight Armrest Downpost Assembly, TB3 V1 and V2 Arms	15
Version 1 Standard Armrest Matrix, TB3 (Grey) - 12"-24" W Seats	5
Version 2 Standard Armrest Matrix , TB3 (Black) - 24"-32" W Seats	3
Version 2 Standard Armrest Matrix , TB3 (Black)- 12"-24" W Seats	1

Appendix B:Parts Index

ARM136408	14	DGN142125	14
ARM136409	14	DGN142128	14
ARM138389	10	DGN143409	10
ARM138390	10	HDW122303	12
ARM138391	10	HDW133899	16, 18, 18
ARM138392	10	HDW134332	10
ARM147696	2	HDW134520	14
ARM147707	10	HDW148456	10
ARM147738	2	MEC121306	12
ARM147739	10	MEC123248	10
ARM147740	2	MEC123250	10
ARM147741	10	MEC124092	16, 18, 18
ARM147742	2	MEC124686	10
ARM147743	2	MEC130240	10
ARM147744	2	MEC130344	10
ARM147745	10	MEC130348	10
ARM147746	2	MEC133236	16, 18
ARM147747	2	MEC133237	16, 18
ARM147748	2	MEC133331	16
ARM147749	2	MEC133900	16, 18, 18
ARM147797	2	MEC137937	18
ARM147810	2	MEC137938	18
ARM147811	2	MEC137979	18
ARM147812	2	MEC138221	10
ARM147813	2	MEC138229	10
ARM147817	2	MEC138230	10
ARM147820	4	MEC138277	10
ARM147821	10	MEC138452	10
ARM147822	4	MEC141919	10
ARM147823	10	MEC141920	10
ARM147838	4	MEC141921	10
ARM147839	4	MEC143410	8
ARM147840	4	MEC143458	8
ARM147841	4	MEC143459	8
ARM147842	4	MEC143460	8
ARM147843	4	MEC143461	8
ARM147844	4	MEC143466	8
ARM147845	10	MEC143469	8
ARM147846	4	MEC143470	8
ARM147847	10	MEC166425	18
ARM147850	4	NUT8120005	12, 12
ARM147855	4	NUTJAM1015	10
ARM147863	4	SCR8120022	10
ARM147864	4	SCRHHCS1282	12
ARM147865	4	SCRHHCS1322	12
ARM147867	4	SCRPPH1304	12, 12
CLPCBLC1028	12, 12	SCRPPH1326	14
DGN123650	12, 12	SCRSETS1105	12, 12
DGN142014	14	SCRSHCS1244	14
DGN142104	14	SCRSHCS1336	10, 12, 12
		WASLOCK1039	12, 12

Illustrated Parts Breakdown

USA - Quantum Rehab

401 York Avenue
Duryea, Pa 18642
www.quantumrehab.com

USA - Pride Mobility Products Corp.

182 Susquehanna Avenue
Exeter, Pa 18643
www.pridemobility.com

Canada

5096 South Service Road
Beamsville, Ontario L0R 1B3
www.pridemobility.ca
www.quantumrehab.com

Australia

20-24 Apollo Drive
Hallam, Victoria 3803
www.pridemobility.com.au
www.quantumrehab.com.au

New Zealand

38 Lansford Crescent
Avondale, Auckland 0600
www.pridemobility.co.nz

UK

32 Wedgwood Road
Bicester, Oxfordshire OX26 4UL
www.pride-mobility.co.uk
www.quantumrehab.co.uk

Netherlands

(Authorised EU Representative)

De Zwaan 3
1601 MS Enkhuizen
www.pridemobility.eu
www.quantumrehab.eu

Italy

Via del Progresso, ang. Via del Lavoro
Loc. Prato della Corte
00065 Fiano Romano (RM)
www.pride-italia.it
www.quantumrehab-italia.it

France

26 Rue Monseigneur Ancel
69800 Saint-Priest
www.pridemobility.fr
www.quantumrehab.fr

Spain

Calle Las Minas Número 67
Polígono Industrial Urtinsa II, de Alcorcón
28923 Madrid

Germany

Hövelrieger Str. 28
33161 Hövelhof
www.pridemobility.de

China

Room 508, Building #4
TianNa Business Zone
No. 500 Jianyun Road
Pudong New Area
Shanghai 201318

